



WORLDWIDE ELECTRIC MOTOR DATA SHEET

FD2-18-145T



HORSEPOWER	2		
RPM / POLES	1800 / 4		
VOLTAGE / PHASE	208-230 V / 1		
FRAME	145T		
ENCLOSURE / DEGREE OF PROTECTION	TEFC / IP55		
FREQUENCY	60 HZ		
FULL LOAD SPEED	1758 RPM		
SERVICE FACTOR	1.15		
INSULATION CLASS	F		
FULL LOAD AMPS	7.8 A		
LOCKED ROTOR AMPS (STARTING)	48.7 A		
NO LOAD CURRENT	1.4 A		
NEMA CODE LETTER	G		
EFFICIENCY / POWER FACTOR	<u>LOAD</u>	<u>EFF.</u>	<u>P.F.</u>
	100%	85.6%	0.98
	75%	83.0%	0.98
	50%	68.2%	0.97
DUTY CYCLE	CONTINUOUS		
TORQUE	<u>FULL LOAD</u>	<u>LRT</u>	<u>BDT</u>
	6.0 lb.ft.	299%	337%
MAX. AMBIENT TEMPERATURE	40° C		
MAX. ELEVATION	3300 Ft. Above Sea Level		
TEMPERATURE RISE (At Full Load)	80° C		
BASE TYPE	Rigid Base		
CAPACITOR (START)	250uF / 300/300V		
CAPACITOR (RUN)	25uF / 450V		
DE BEARINS	6205ZZ		
ODE BEARING	6203ZZ		
REGREASING INT. - DE BEARING	---		
REGREASING INT. - ODE BEARING	---		
GREASE TYPE	Multemp SRL		
MOUNTING	F1		
ROTATION	Bi-Directional		
SHAFT MATERIAL	1045 Carbon Steel		
CONNECTION DIAGRAM	230 V - 4 Lead		
APPROXIMATE WEIGHT	54 lbs.		





WORLDWIDE ELECTRIC MOTOR DRAWING

FD-145T

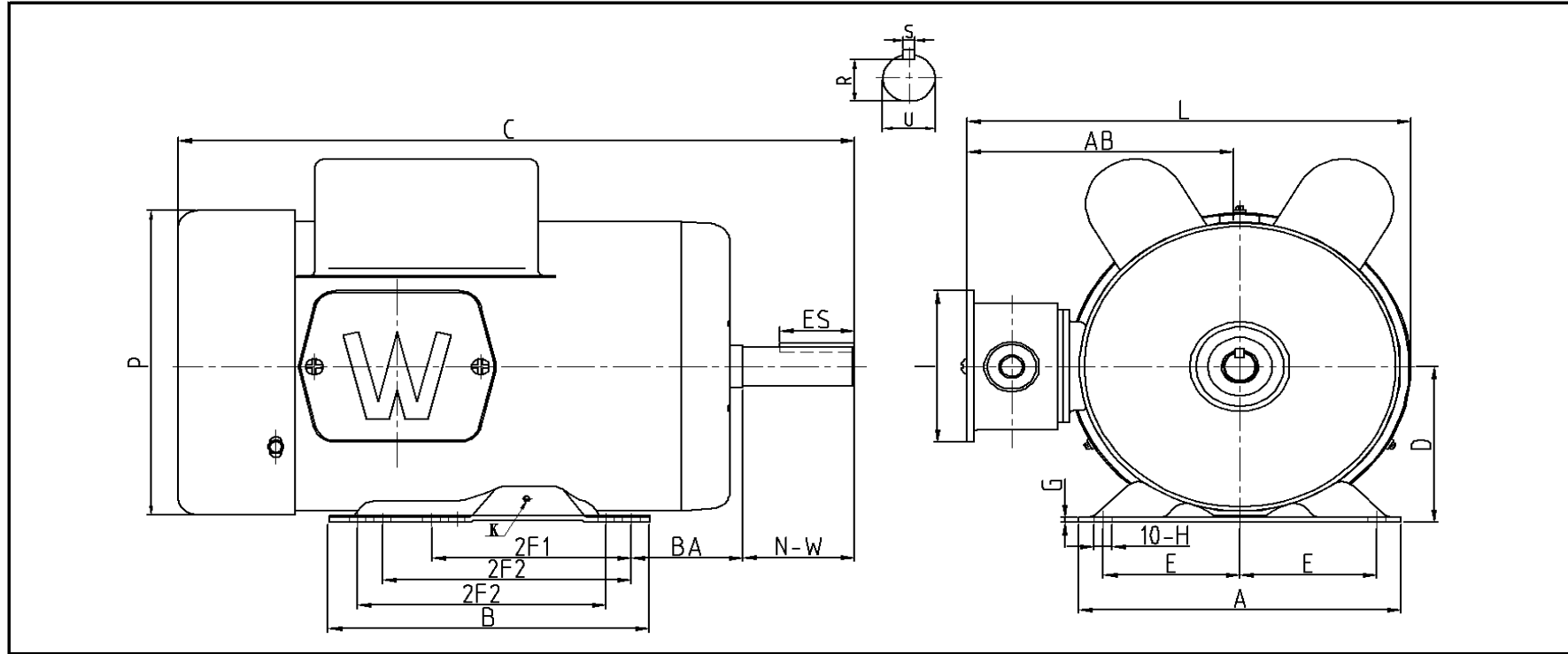

DIMENSIONS - INCHES

MOUNTING									
E	2F1	2F2	H	BA	A	B	C	D	G
2.75	4	5	0.35	2.25	6.5	6.5	13.8	3.5	0.12

KEYSET	KEY								
R	ES	S	U	N-W	P	AB	I	L	
0.771	1.375	0.188	0.875	2.25	6.8	5.4	3.4	9.1	